

The information contained in this drawing is the sole property of CWS Coil Winding Specialist. Any reproduction in part or whole without written permission of CWS Coil Winding Specialist is prohibited.

DIMENSIONAL TOLERANCES
INCHES (MM)

A	B	C	D	X
MAX	MAX	TYP	REF	REF
1.13 [28.70]	0.53 [13.50]	0.50 [12.70]	0.05 [1.27]	1.05 [26.67]

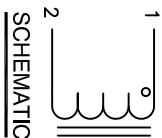

7 BUILD TO ROHS COMPLIANCE AND LEAD FREE.

USING A PERMANENT MARKING METHOD

MARK PART NUMBER, REVISION AND DATE CODE

WRAP INDUCTOR WITH 3M # 79 OR EQUAL

5 (I.E. COIL MUST REST FLAT ON PCB). LEADS MUST BE TANGENT TO THE CORE REMOVE INSULATION AND TIN LEADS 0.5 INCH, FLUSH WITH THE COIL EDGE

4 WIND COILS EVENLY SPACED AROUND THE CORE CONSTRUCTION:

THESE SPECIFICATIONS ARE BASED ON LOW RIPPLE CURRENT

WEIGHT: 50 GRAMS TYPICAL

INTERWINDING CAPACITANCE = 16.3pF TYP @ SRF

SRF = 5.33MHz TYPICAL

|Z| = 6.7K Ω -OHMS TYP @ SRF

RECOMMENDED AMBIENT OPERATING TEMP: -40°C TO 155°C

HI-POT TEST FOR WINDING TO CORE ISOLATION = 500VDC MIN.

INDUCTOR CURRENT RATING : 8.3 AMPS, 40°C TEMP. RISE WITH SOME AIR FLOW

DCR = 22 MILLI-OHMS MAX.

INDUCTOR DC BIAS: SEE TABLE ON THE RIGHT

INDUCTANCE = 50 μ H \pm 10% @ 0 AMP DC BIAS, 1.0 KHz, 250mV

3 SPECIFICATIONS: @ 25°C:

WIRE: UL RECOGNIZED 200°C RATED MAGNET WIRE

CORE: POWDERED TOROIDAL CORE, CWS BYTEMARK OR OTHER APPROVED PART

1 MATERIAL: UL RECOGNIZED 94V-0 FOR FLAMMABILITY, RATING CLASS B (130°C MIN.) REQUIRED ANY TOLERANCE. THIS DIM. CAN VARY A LITTLE FROM PART TO PART.

TYP IN DIM. TABLE REFERS TO A NON-CRITICAL TYPICAL (AVERAGE) DIM. WITHOUT

NOTES: UNLESS OTHERWISE STATED, READ NOTES FROM BOTTOM UP.

CAGE CODE: 5DMEZ

REVISION HISTORY

REV	ECN	DESCRIPTION	BY	DATE	CHK	DATE
C	-	UPDATED SPEC.	TN	07/14/2020	JL	07/14/2020
C1	-	REVISED OD AND HEIGHT SPEC.	TN	04/27/21	JL	04/27/21
C2	-	REVISED DIM B SPEC.	TN	06/22/21	JL	06/22/21

DC BIAS TABLE

DC BIAS (AMP)	L@ 1KHz (REF)
0	51 μ H
1	51 μ H
2	51 μ H
4	50 μ H
6	49 μ H
8	47 μ H
8.3	47 μ H

BOTTOM VIEW

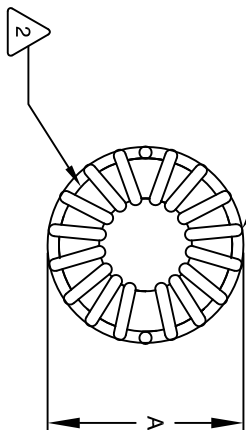

FRONT VIEW

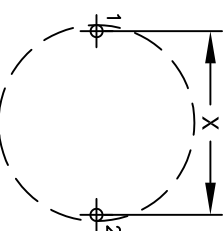
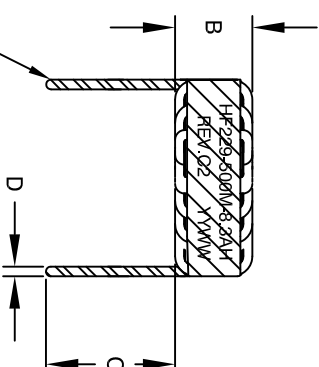

MOUNTING HOLES PATTERN

PARTS LIST

CODE	IDENT	MFG. P/N	DESCRIPTION	ITEM NO.
AUTOCAD	SIGN	DATE	TITLE	
SOLIDWORKS	TOK	2/8/04	COILWS.COM, INC	
DRWIN	JLJU	2/9/04	www.coilws.com	
ENGR.	KSUM	3/5/04	CWS Coil Winding Specialist.	
APPR.	JLJU	3/6/04	1510 E. Edinger Ave.	
			Unit B, Santa Ana, CA. 92705	
			SIZE	REV
			1/4	C2
			2=1	